



CHATTERTON | REES



Weatherby Talbot Road, London, W2 5LF

**£750,000**

A brilliant two/ three bedroom split level apartment on Talbot Road in Notting Hill. Spread over the first and second floor of a purpose built block there are two double bedrooms and one bathroom a large semi open kitchen to the living and dining room that has the benefit of direct access on to a south facing terrace.

There is a study room that has in the past been used as a guest bedroom.

The property is in good condition and has 823sqft of internal space, a recently extended lease with a beautiful view of Talbot Road and only moments from Portobello Road and plenty of restaurants and shops almost on your doorstep.



# Floor Plan

## Talbot Road

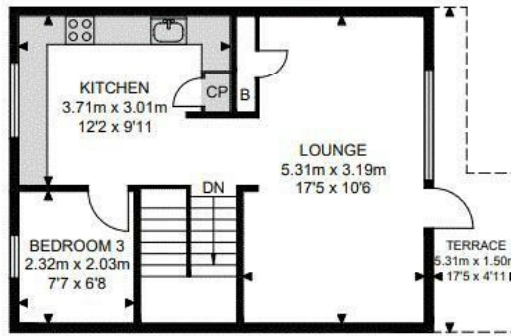

2nd Floor

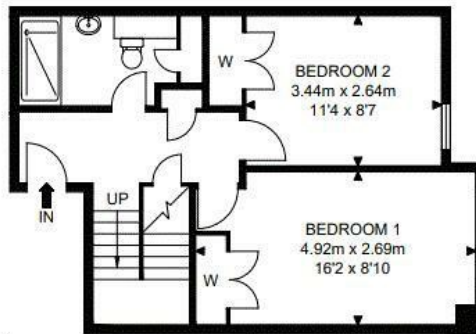

1st Floor



APPROX. GROSS INTERNAL FLOOR AREA 832.05 SQ FT / 77.30 SQM  
 APPROX. GROSS EXTERNAL FLOOR AREA 63.50 SQ FT / 5.90 SQM

Whilst every attempt has been made to ensure the accuracy of the floor plan contained here, measurements of doors, windows, rooms and any other items are approximated and no responsibility is taken for any error, omission or mis-statement. This plan is for illustrative purposes only and should be used as such by any prospective purchaser. The service, system and appliances shown have not been tested and no guarantee as to their operability or efficiency can be given.

© SpacePhoto

Photography and Floor Plan

## Area Map

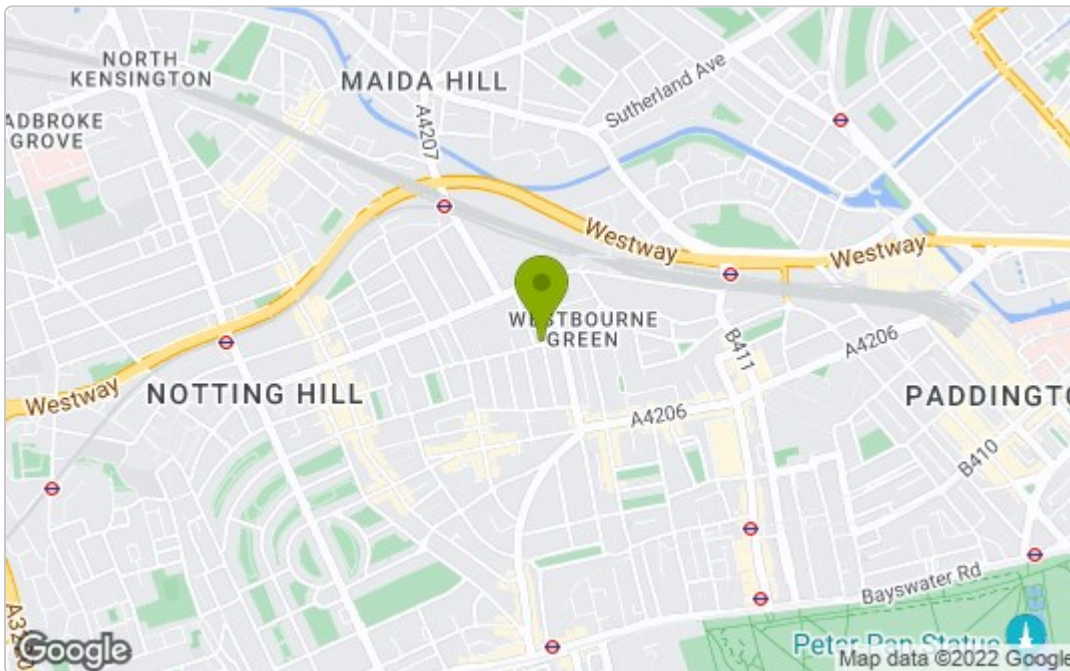

## Energy Efficiency Graph

| Energy Efficiency Rating  |         |           |
|---|---------|-----------|
|   | Current | Potential |
| Very energy efficient - lower running costs                     |         |           |
| (92 plus) <b>A</b>  |         |           |
| (81-91) <b>B</b>  |         |           |
| (69-80) <b>C</b>  |         |           |
| (55-68) <b>D</b>  |         |           |
| (39-54) <b>E</b>  |         |           |
| (21-38) <b>F</b>  |         |           |
| (1-20) <b>G</b>   |         |           |
| Not energy efficient - higher running costs                     |         |           |
| <b>England &amp; Wales</b> EU Directive 2002/91/EC              |         |           |
| Environmental Impact (CO <sub>2</sub> ) Rating                  |         |           |
|   | Current | Potential |
| Very environmentally friendly - lower CO <sub>2</sub> emissions |         |           |
| (92 plus) <b>A</b>  |         |           |
| (81-91) <b>B</b>  |         |           |
| (69-80) <b>C</b>  |         |           |
| (55-68) <b>D</b>  |         |           |
| (39-54) <b>E</b>  |         |           |
| (21-38) <b>F</b>  |         |           |
| (1-20) <b>G</b>   |         |           |
| Not environmentally friendly - higher CO <sub>2</sub> emissions |         |           |
| <b>England &amp; Wales</b> EU Directive 2002/91/EC              |         |           |

These particulars, whilst believed to be accurate are set out as a general outline only for guidance and do not constitute any part of an offer or contract. Intending purchasers should not rely on them as statements of representation of fact, but must satisfy themselves by inspection or otherwise as to their accuracy. No person in this firm's employment has the authority to make or give any representation or warranty in respect of the property.